

Questions? Be safe, not sorry.

800-521-2232

Duke Energy looks forward to providing you with reliable and efficient electrical service. This

brochure outlines the steps to be completed before your temporary overhead electrical service can be connected.

The illustration inside shows the items you are responsible for supplying and/or installing. If you have questions about any of these specifications or if your installation differs from the one shown here, please contact Duke Energy at 800-521-2232 to apply for service. We will be happy to explain these requirements to you or suggest other sources of help.

To schedule installation of electrical service, please refer to our Checklist For Service Installation. If you do not have a copy of this checklist, please ask for one when you call. We look forward to serving you!

Issuance of this brochure does not release the customer from responsibility to install, operate and maintain facilities in an approved and safe manner, nor does Duke Energy assume any duty to inspect such facilities or to otherwise determine their adequacy or condition.

Duke Energy may revise, without notice, the requirements outlined in this brochure. The customer is obligated to maintain their facilities in accordance with all applicable revised Duke Energy requirements.

All wiring installations must meet the requirements of the National Electrical Code, the National Electrical Safety Code, local codes and ordinances, and inspection authorities, as well as the terms and conditions of electric service of Duke Energy as approved by the Indiana Utility Regulatory Commission.

Equipment and wiring must not present a hazard to Duke Energy personnel, the customer or the general public.

Use of electric energy must not cause unreasonable voltage variations on the Duke Energy lines or disturbances to the service of other customers.

The decisions of local inspection authorities will override the information in this brochure concerning customer equipment. This does not include the location of the meter base.

Ownership of facilities shall remain with the party which supplied the facilities regardless of the party responsible for installation, except as otherwise agreed upon and indicated in writing and on

file with Duke Energy. Maintenance of such facilities shall be the responsibility of the owner.

**Stay away from power lines.**



# Temporary Overhead Service



# Temporary Overhead Service

Temporary Overhead Service	Meter Base Guidelines
<b>Service Type—120/240 volt, single phase 3-wire</b>	<b>Manufacturers</b>
Residential Overhead 100 amp service, 1 meter position	Milbank, Durham/Square D Landis & Gyr, T&B/Anchor
Residential Overhead/Underground 200 amp service, 1 meter position	Milbank, Durham/Square D, Landis & Gyr, T&B/Anchor

A non-refundable charge for temporary service will be required. The cost of a standard overhead temporary service is \$200 if the service is 100' or less.

20 ft. pole with a top diameter of at least 5 in. Contact Duke Energy to determine location of pole.

SE conductors must extend 3 ft. out of weatherhead

Riser – Service entrance conductors can be either SE cable or conductors in conduit

Breaker Size	Customer Wire Sizes					
	Ⓜ Minimum Line Conductor		Ⓝ Neutral Conductor		Ground Wire	
	Alum.	Copper	Alum.	Copper	Alum.	Copper
100 AMP	#2	#4	#6	#8 - #4	#6	#8 - #4
200 AMP	#4/0	#2/0	#2 - #2/0	#4 - #1	#2	#6 - #4

● Indicates recommended size

Meter base – Install the meter base with the center 5 ft. 6 in. above ground

Weatherproof fused disconnecting device

Weatherproof, grounding type receptacles with ground-fault circuit interrupter protection

Minimum pole depth of 5 ft. If depth cannot be attained, guying or bracing may be required.

Ⓜ	Hot wires
Ⓝ	Neutral Wires
■	Items you supply and install
●	Items Duke Energy supplies and installs

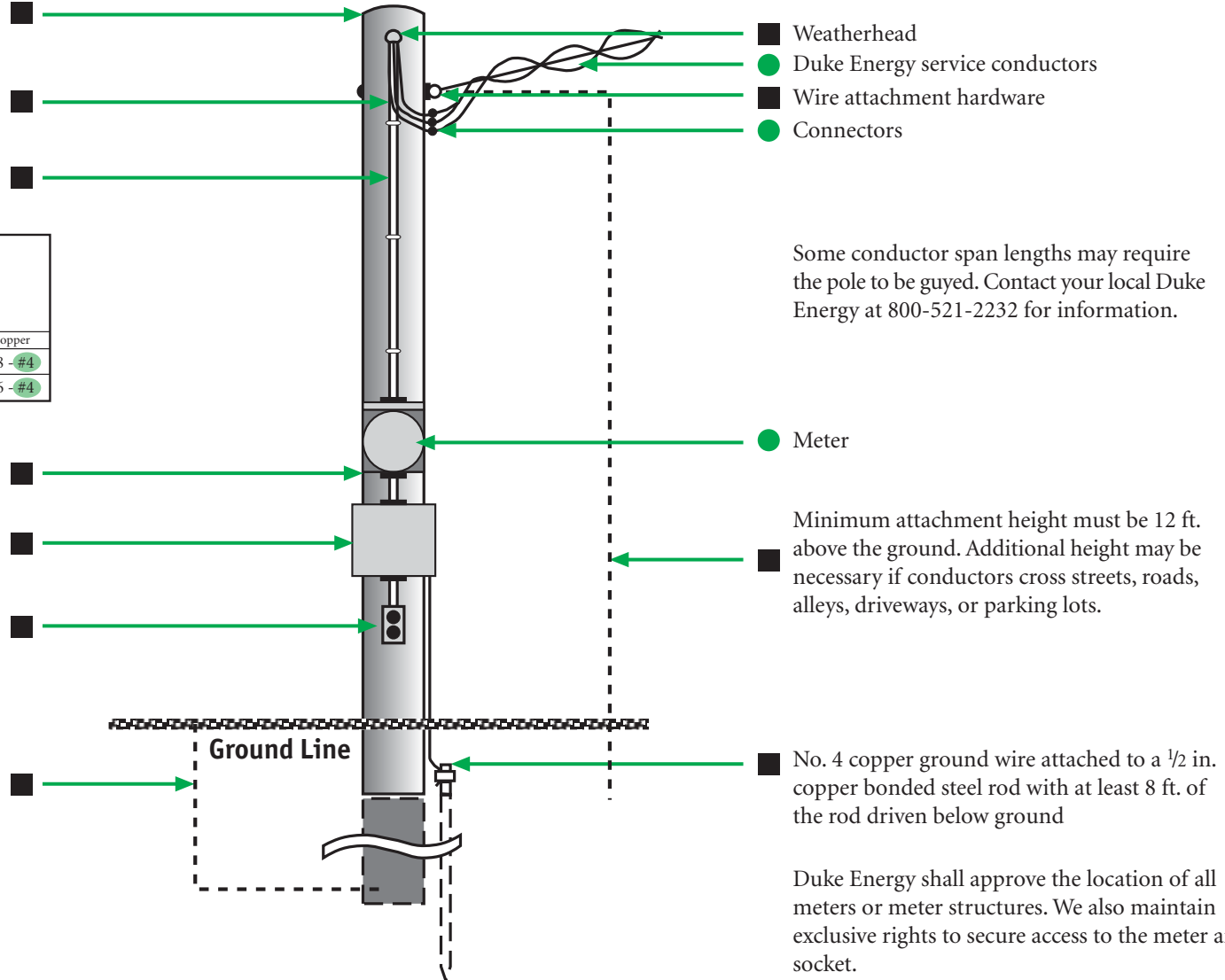

- Weatherhead
- Duke Energy service conductors
- Wire attachment hardware
- Connectors

Some conductor span lengths may require the pole to be guyed. Contact your local Duke Energy at 800-521-2232 for information.

- Meter

Minimum attachment height must be 12 ft. above the ground. Additional height may be necessary if conductors cross streets, roads, alleys, driveways, or parking lots.

- No. 4 copper ground wire attached to a 1/2 in. copper bonded steel rod with at least 8 ft. of the rod driven below ground

Duke Energy shall approve the location of all meters or meter structures. We also maintain exclusive rights to secure access to the meter and socket.

All equipment must be in good condition and installed to meet National Electrical Code requirements.

**in Indiana 800-382-5544 "call before you dig"**